

**EXTERIOR MASONRY OR CONCRETE BLOCK WALL  
(SECTION)**

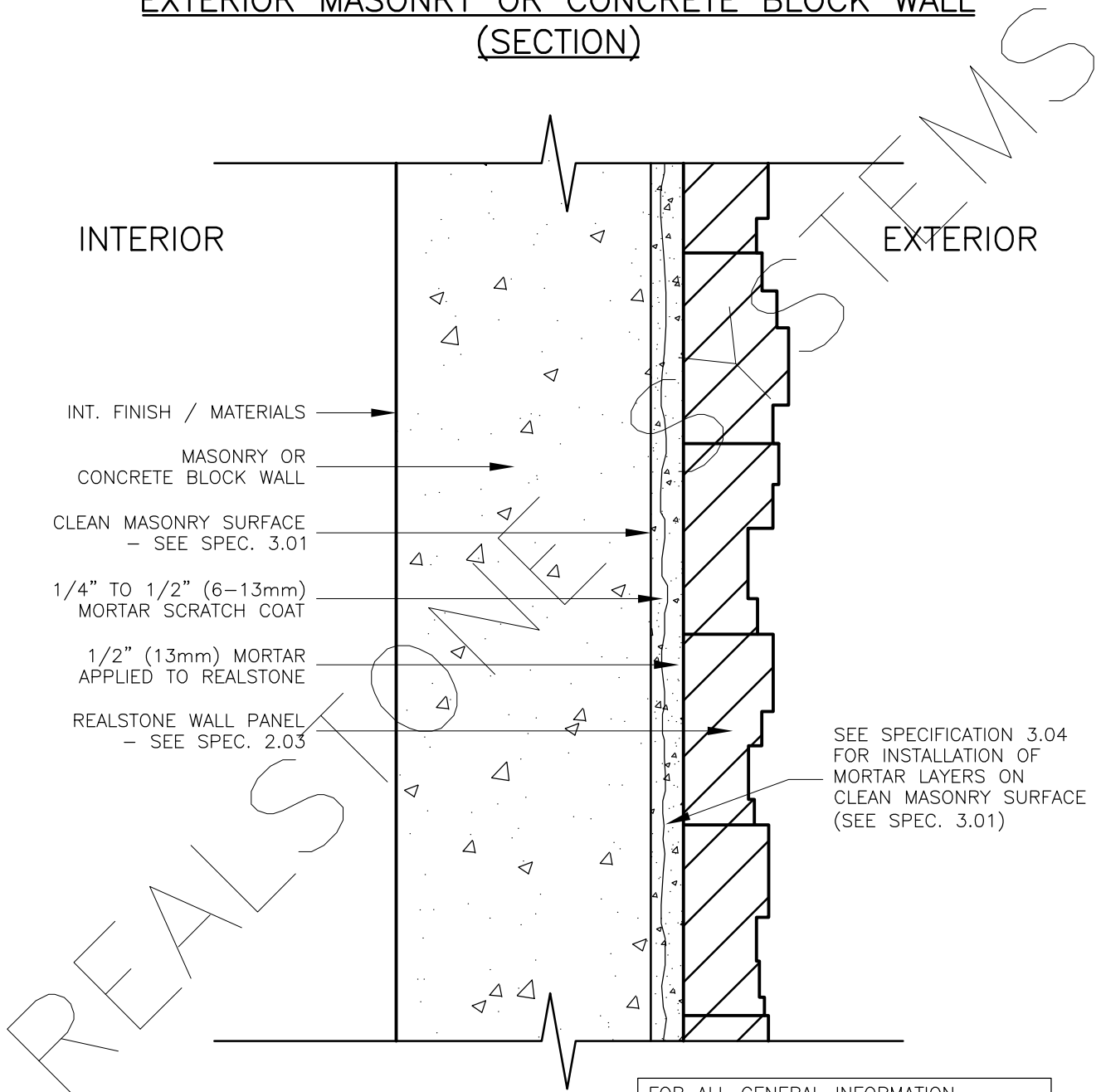

FOR ALL GENERAL INFORMATION  
REGARDING MORTAR MIXES, STONE  
INSTALLATION AND SEQUENCING, REFER  
TO MASTER GUIDE SPECIFICATIONS

**DRAWING DESCRIPTION:**

THIS DETAIL ILLUSTRATES THE REALSTONE SYSTEM INSTALLED ON AN EXTERIOR MASONRY OR CONCRETE BLOCK WALL. THE INSTALLATION PROCESS IS THE SAME AS CEMENT BOARD (SEE SPEC. 3.04). THE SURFACE OF THE MASONRY OR CONCRETE BLOCK WALL MUST BE CLEANED FIRST, TO REMOVE ALL FORM-RELEASE AGENTS, DUST, COATINGS, ECT. (SEE SPEC. 3.01-A). IF INSULATION IS INSTALLED ON THE OUTSIDE OF THE MASONRY WALL, A METAL LATH OR CEMENT BOARD WILL HAVE TO BE INSTALLED BEFORE INSTALLING THE REALSTONE SYSTEM.

SHEET NO:

D-13

DRAWING: EXT. WALL - MASONRY - (SECTION)

**realstone SYSTEMS™**  
Realstone Simply Installed

NOTE: REALSTONE SYSTEMS' DETAILS ARE PROVIDED FOR THE CLARIFICATION OF THE MANUFACTURED PRODUCT, ITS APPLICATIONS AND TO ASSIST IN THE PROCESS OF PROJECT SPECIFIC DETAILS. DESIGN PRINCIPLES AND SPECIFICATIONS INCORPORATED IN THE FINAL DETAILS ARE THE RESPONSIBILITY OF THE PROJECT DESIGN PROFESSIONAL IN COMPLIANCE WITH THE LOCAL BUILDING CODE.

SCALE: 1:5

DATE: 08-12-12