

**EXTERIOR MASONRY OR CONCRETE BLOCK WALL  
(PLAN)**

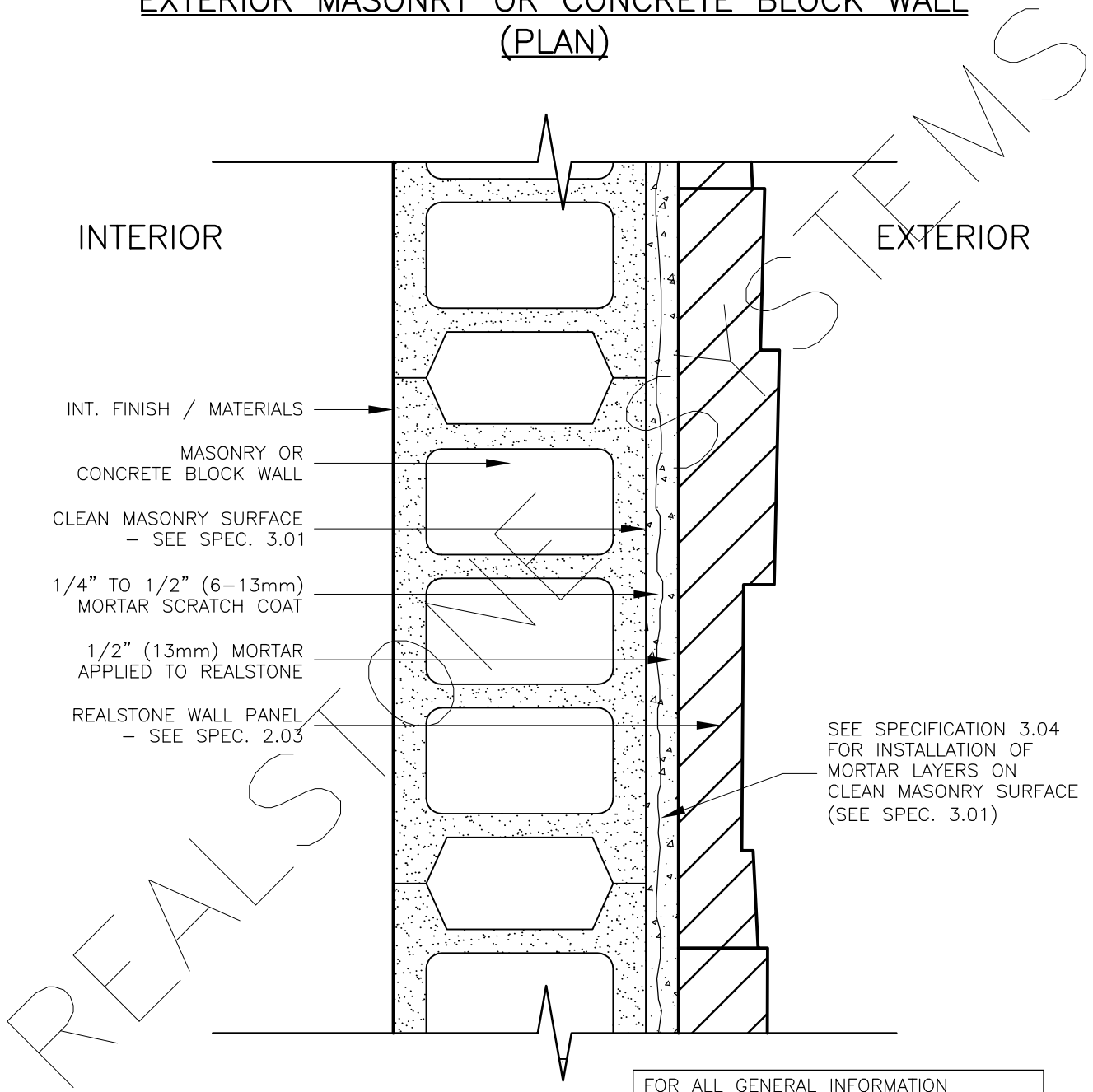

INTERIOR

EXTERIOR

- INT. FINISH / MATERIALS
- MASONRY OR CONCRETE BLOCK WALL
- CLEAN MASONRY SURFACE  
- SEE SPEC. 3.01
- 1/4" TO 1/2" (6-13mm)  
MORTAR SCRATCH COAT
- 1/2" (13mm) MORTAR  
APPLIED TO REALSTONE
- REALSTONE WALL PANEL  
- SEE SPEC. 2.03

SEE SPECIFICATION 3.04 FOR INSTALLATION OF MORTAR LAYERS ON CLEAN MASONRY SURFACE (SEE SPEC. 3.01)

FOR ALL GENERAL INFORMATION REGARDING MORTAR MIXES, STONE INSTALLATION AND SEQUENCING, REFER TO MASTER GUIDE SPECIFICATIONS

**DRAWING DESCRIPTION:**

THIS DETAIL ILLUSTRATES THE REALSTONE SYSTEM INSTALLED ON AN EXTERIOR MASONRY OR CONCRETE BLOCK WALL. THE INSTALLATION PROCESS IS THE SAME AS CEMENT BOARD (SEE SPEC. 3.04). THE SURFACE OF THE MASONRY OR CONCRETE BLOCK WALL MUST BE CLEANED FIRST, TO REMOVE ALL FORM-RELEASE AGENTS, DUST, COATINGS, ECT. (SEE SPEC. 3.01-A). IF INSULATION IS INSTALLED ON THE OUTSIDE OF THE MASONRY WALL, A METAL LATH OR CEMENT BOARD WILL HAVE TO BE INSTALLED BEFORE INSTALLING THE REALSTONE SYSTEM.

SHEET NO:  
**D-14**

DRAWING: **EXT. WALL - MASONRY - (PLAN)**

**realstone SYSTEMS™**  
Realstone Simply Installed

NOTE: REALSTONE SYSTEMS' DETAILS ARE PROVIDED FOR THE CLARIFICATION OF THE MANUFACTURED PRODUCT, ITS APPLICATIONS AND TO ASSIST IN THE PROCESS OF PROJECT SPECIFIC DETAILS. DESIGN PRINCIPLES AND SPECIFICATIONS INCORPORATED IN THE FINAL DETAILS ARE THE RESPONSIBILITY OF THE PROJECT DESIGN PROFESSIONAL IN COMPLIANCE WITH THE LOCAL BUILDING CODE.

SCALE: **1:5**

DATE: **08-12-12**