

INTERIOR STUD WALL (CEMENT BOARD) GENERIC FIREPLACE FLUSH WITH REALSTONE FACADE (SECTION)

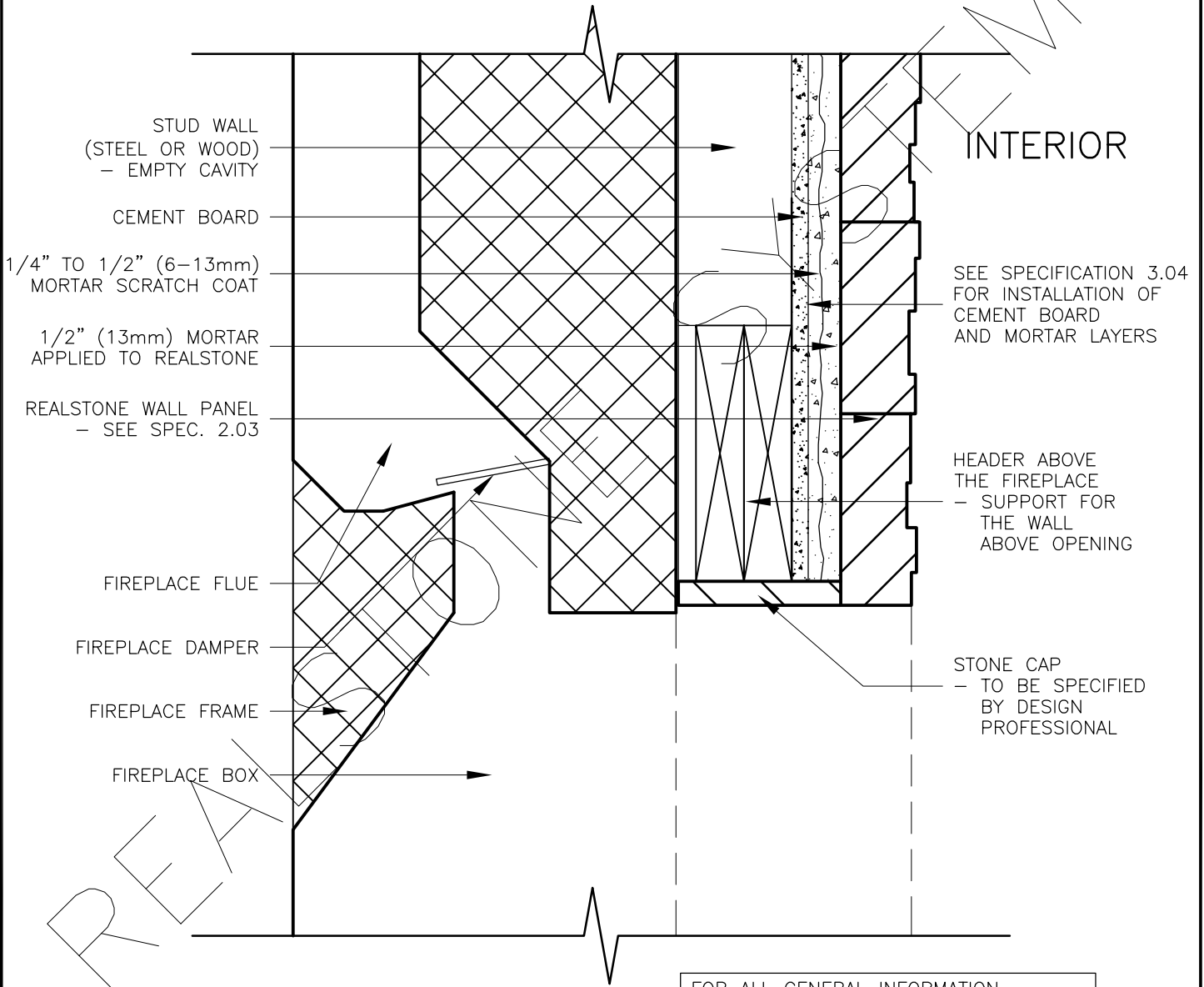

FOR ALL GENERAL INFORMATION REGARDING MORTAR MIXES, STONE INSTALLATION AND SEQUENCING, REFER TO MASTER GUIDE SPECIFICATIONS

DRAWING DESCRIPTION:

THIS DETAIL ILLUSTRATES THE REALSTONE SYSTEM INTERGRATED WITH A MANUFACTURED FIREPLACE. THE REALSTONE FACADE ILLUSTRATED IS FLUSH WITH THE FIREPLACE (THIS DETAIL MAY HAVE TO BE ALTERED TO ACCOMMODATE THE STYLE OF FIREPLACE). ALL FIREPLACE SPECIFICATIONS, RESTRICTIONS AND DETAILS TO BE SPECIFIED BY THE DESIGN PROFESSIONAL IN COMPLIANCE WITH THE MANUFACTURE'S SPECIFICATIONS AND LOCAL BUILDING CODE.

SHEET NO:
D-33

DRAWING: INT. WALL - FLUSH W/ FIREPLACE - (SECTION)

realstone SYSTEMS™
Realstone Simply Installed

NOTE: REALSTONE SYSTEMS' DETAILS ARE PROVIDED FOR THE CLARIFICATION OF THE MANUFACTURED PRODUCT, ITS APPLICATIONS AND TO ASSIST IN THE PROCESS OF PROJECT SPECIFIC DETAILS. DESIGN PRINCIPLES AND SPECIFICATIONS INCORPORATED IN THE FINAL DETAILS ARE THE RESPONSIBILITY OF THE PROJECT DESIGN PROFESSIONAL IN COMPLIANCE WITH THE LOCAL BUILDING CODE.

SCALE: 1:5

DATE: 08-12-12